

# gregory Model RP-EX

## Rider Pallet Explosion Proof Truck

Specifications for 4,000 lb., 6,000 lb. and 8,000 lb. Capacities

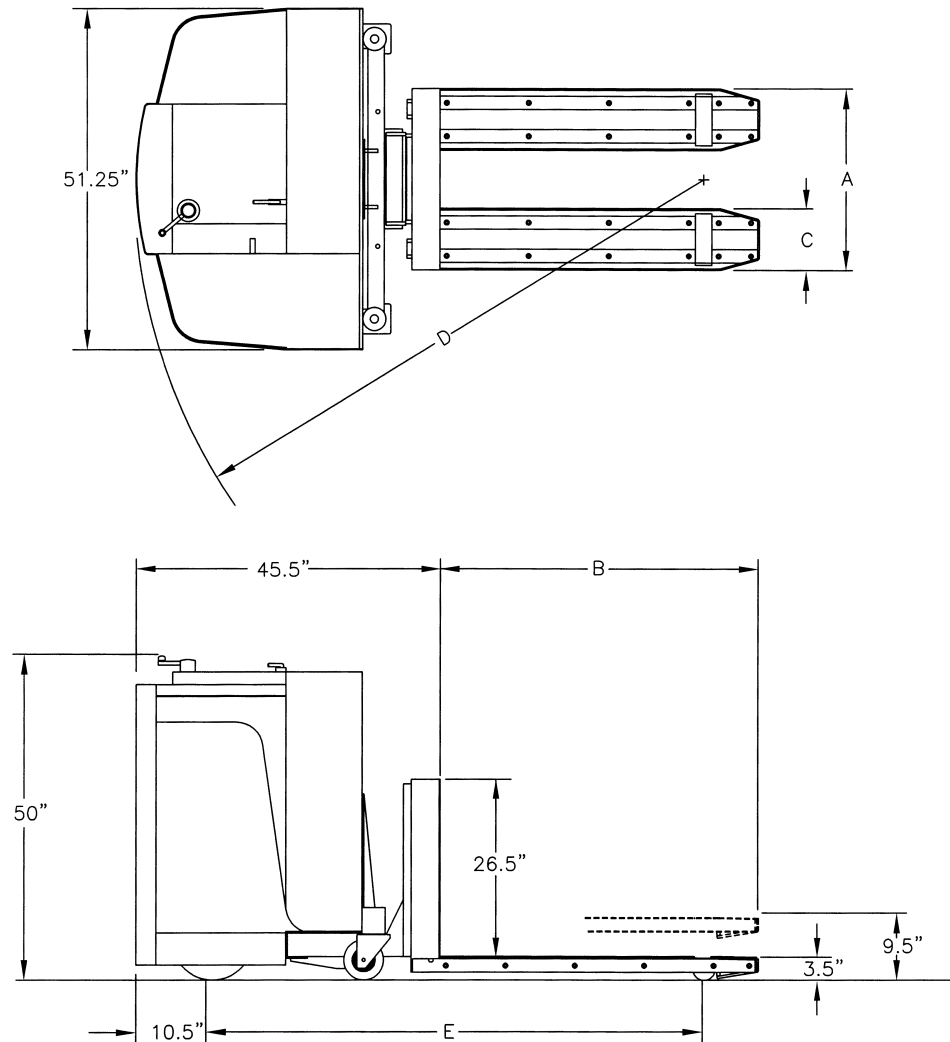

★ All Gregory Explosion Proof (EX) rated forklifts can be custom designed in accordance with the individual specifications of each customer.

★ Specifications on this sheet provide standard dimensions for 4,000 lb., 6,000 lb. and 8,000 lb. capacity RP models.

★ Contact the Excalibur Equipment Sales Department for custom requirements or special fork sizes.

### Standard Specifications (inches) Specifications Include Bronze Trim

Fork Sizes	(A) Fork Spread <sup>1</sup>	(B) Length <sup>2</sup>	(C) Fork Width <sup>3</sup>	(D) Turning Radius	(E) Wheelbase
27 x 42	27.25	42	9.25	80	69
27 x 48	27.25	48	9.25	86	75
27 x 54	27.25	54	9.25	92	81

<sup>1</sup> Standard Fork Spread from 24.25" to 50.25" in 1" increments

<sup>2</sup> Standard Lengths from 36" to 72" in 6" increments

<sup>3</sup> Standard Fork Width for 8,000 lb. capacity increases to 10.25"

Classified to U.S. and Canadian Safety Standards by Underwriters Laboratories Inc. for Use in Class I, Divisions 1 & 2, Groups C & D; Class II, Divisions 1 & 2, Group G; and Class III, Divisions 1 & 2 Hazardous Environments.



Rider Pallet Explosion Proof Truck		
<b>General Information</b>	<b>Manufacturer</b>	Excalibur Equipment, LLC
	<b>Model</b>	Gregory RP4EX, RP6EX and RP8EX
	<b>Capacity</b>	RP4EX - 4,000 lb. at 24" Load Center RP6EX - 6,000 lb. at 24" Load Center RP8EX - 8,000 lb. at 24" Load Center
	<b>Rating</b>	UL Classified Explosion Proof
	<b>Power</b>	24 Volt Electric
	<b>Electric Controls</b>	Transistorized, Solid State Infinitely Variable Programmable Speed, Acceleration and Plugging Capabilities
	<b>Hydraulic Controls</b>	Point of Action Electric / Hydraulic Infinitely Variable
	<b>Motors (Drive, Lift, Power Steering)</b>	Heavy Duty Explosion Proof with Class "H" Insulation, UL Classified
	<b>Forks</b>	Heavy Duty Reinforced Steel
	<b>Truck Weight (Less Battery)</b>	2,125 lbs.
	<b>Paint</b>	Safety Yellow
<b>Dimensions</b>	<b>Specifications and Fork Options Shown on Front</b>	
<b>Performance</b>	<b>Maximum Travel Speeds</b>	4.8 mph Empty, 4.0 mph Loaded Programmable
	<b>Equal Intersecting Aisle</b>	71" based on a 48" Fork Length
	<b>Right Angle Stacking</b>	95" based on a 48" Fork Length
	<b>Gradeability</b>	10%
<b>Chassis</b>	<b>Wheels, Drive</b>	(2) 12" x 3.5" Static Conductive Rubber
	<b>Wheels, Load</b>	(4) 3.38" x 2.88" High Durometer Polyurethane
	<b>Wheels, Caster</b>	(2) 6" x 3" High Durometer Polyurethane
	<b>Brake</b>	Deadman Foot Pedal
	<b>Underclearance</b>	2.25" Standard Higher Ramp Underclearances Available
<b>Battery and Charger Requirements</b>	<b>Battery Type</b>	UL Classified Explosion Proof
	<b>Battery Capacity</b>	500 Amp Standard - 620 Amp Available
	<b>Battery Compartment</b>	11.25" x 25.6" x 34.5" Side Removal
	<b>Battery Weight</b>	985 lbs.
	<b>Charger Connector</b>	N2106 Explosion Proof

Excalibur Equipment produces a complete line of specialized Material Handling Equipment. Continuous improvements in safety, performance and durability assure customers of a quality forklift designed to meet their specifications.

All vehicles are furnished with UL mandated safety devices and under no circumstances should these devices be removed. Gregory products and specifications are subject to improvements and changes without notice and obligation on prior purchases.

**Standard Features**  
 24 Volt System  
 Articulated Chassis  
 Battery Discharge Indicator w/ Lift Interrupt  
 Sight Glass  
 Battery Roller Tray  
 Bronze Anti-Spark Package  
 Electric Horn and Back-Up Alarm Package  
 Emergency Power Disconnect  
 Hourmeter  
 Hydrostatic Power Steering  
 Polyurethane Load and Caster Wheels  
 Static Conductive Drive Tires  
 Transistorized Controls

**Optional Features**  
 12 Volt System (shortens wheelbase)  
 Epoxy Paint  
 Hand Held Analyzer  
 On/Off Key Switch  
 Remote In-Environment Charging Station  
 Stainless Steel Construction  
 Skid Adapter  
 Strobe Light (pedestal mounted)

**Gregory EX Trucks** are Classified to U.S. and Canadian safety standards by Underwriters Laboratories Inc. for use in **Class I, Divisions 1 & 2, Groups C & D; Class II, Divisions 1 & 2, Group G; and Class III, Divisions 1 & 2** Environments.

All Gregory EX trucks are classified by UL to the following Standards for Safety:

**UL 583**

Electric-Battery-Powered Industrial Trucks

**UL 1203**

Explosion Proof and Dust-Ignition-Proof Electrical Equipment for Use in Hazardous (Classified) Locations

**UL 1604**

Electrical Equipment for Use in Class I and Class II, Division 2, and Class III Hazardous (Classified) Locations

## EXCALIBUR EQUIPMENT, LLC

285 Eldridge Road Fairfield, NJ 07004-2508  
 phone: (973) 808-8399 fax: (973) 808-8398  
[www.exequipment.com](http://www.exequipment.com)  
[sales@exequipment.com](mailto:sales@exequipment.com)